

**4** **2** **3/4"=1'-0"**

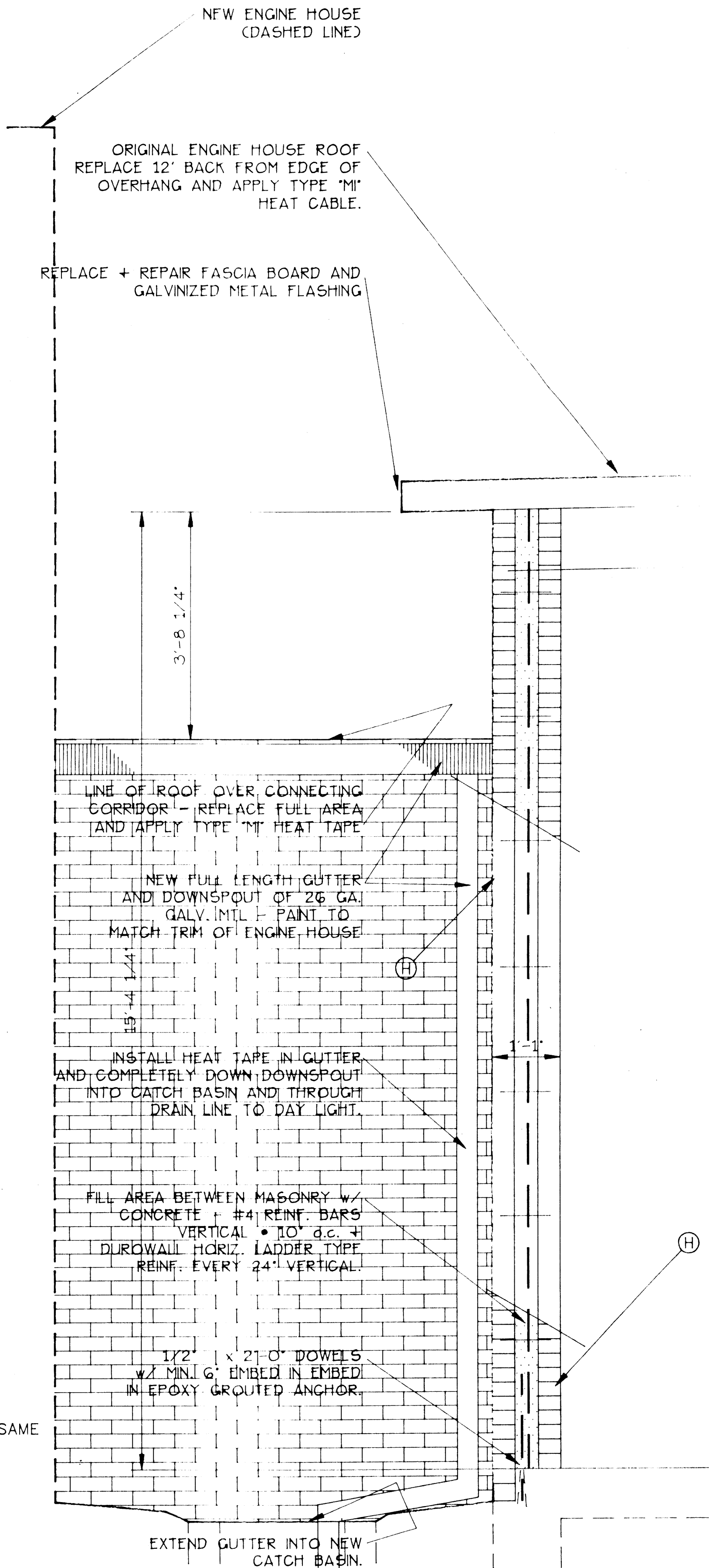

**3** **2** **3/4"=1'-0"**

**1** **2** **1/4"=1'-0"**

**LETTERED NOTES**

- (A)** ALL WORK TO BE ACCOMPLISHED DURING STANDARD C&TS RR WORK DAYS - FULL OPERATION OF FACILITIES IS REQUIRED. TEMPORARY SHUT DOWN OF FACILITIES MUST BE APPROVED IN WRITING BY C&TS RR 48 HOURS PRIOR TO SHUT DOWN. CONTACT MR. LEO SCHMITZ (719) 376-5488
- (B)** TEMPORARILY DETACH ALL ELECTRICAL BOXES AND CONDUIT FROM DEMOLITION AREA. PROVIDE NECESSARY SUPPORT FOR DEVICES UNTIL NEW WALL IS COMPLETE. RE-ATTACH TO NEW WALL.
- (C)** REMOVE EXISTING METAL SIDING AND FRAMING OF STORAGE FACILITY. REMOVE ALL JOISTS USED FOR STORAGE AREA ROOFING. DO NOT REMOVE ANY MAIN TIMBERS OR TIMBERS NECESSARY FOR STABILITY OF EXISTING ROUNDHOUSE.
- (D)** PROVIDE WEATHERPROOF BARRIER AT ALL OPEN WALLS DURING THE CONSTRUCTION PROCESS - THIS IS ONLY NECESSARY AT THE MACHINE SHOP.
- (E)** REMOVE ALL DETERIORATING MASONRY UNITS COMPLETELY AND REPLACE WITH SALVAGED BRICK FROM REMOVED WALL AREAS THAT ARE OF SOUND CONDITION. POINT ALL MASONRY JOINTS WITH TYPE "S" (fc=2000 psi) MORTAR - WASH BRICK WITH WATER ONLY!
- (F)** EXISTING BOLTED TIMBER WALL STIFFENERS TO REMAIN, DO NOT REMOVE MASONRY FURTHER THAN THIS MEMBER. RE-INSTALL PER DETAILS THIS SHEET, TOOTH MASONRY.
- (G)** REMOVE MASONRY TO EXISTING FOOTING CONTRACTOR TO DETERMINE AND RECOMMEND RECONSTRUCTION METHODS BASED ON INVESTIGATIONS OF THE EXISTING FOUNDATION.
- (H)** AT NEW WALL SECTION - REUSE EXISTING BRICK FOR EXTERIOR FACE, SHOULD QUANTITY BE LESS THAN REQUIRED REBUILD WITH NEW BRICK THAT EXACTLY MATCH THE NEW MASONRY CONSTRUCTION OF THE CONNECTING CORRIDOR. INTERIOR BRICK MAY BE RE-USED OR NEW. UNDER NO CIRCUMSTANCES WILL A COMBINATION OF NEW AND OLD MASONRY BE PERMITTED ON THE SAME WALL SURFACE!

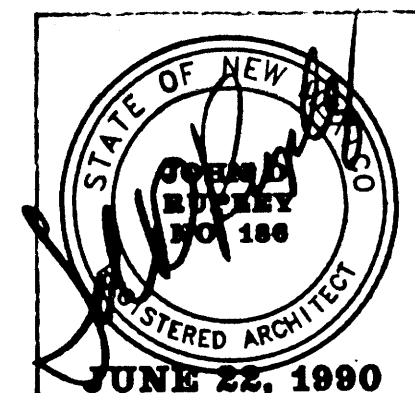
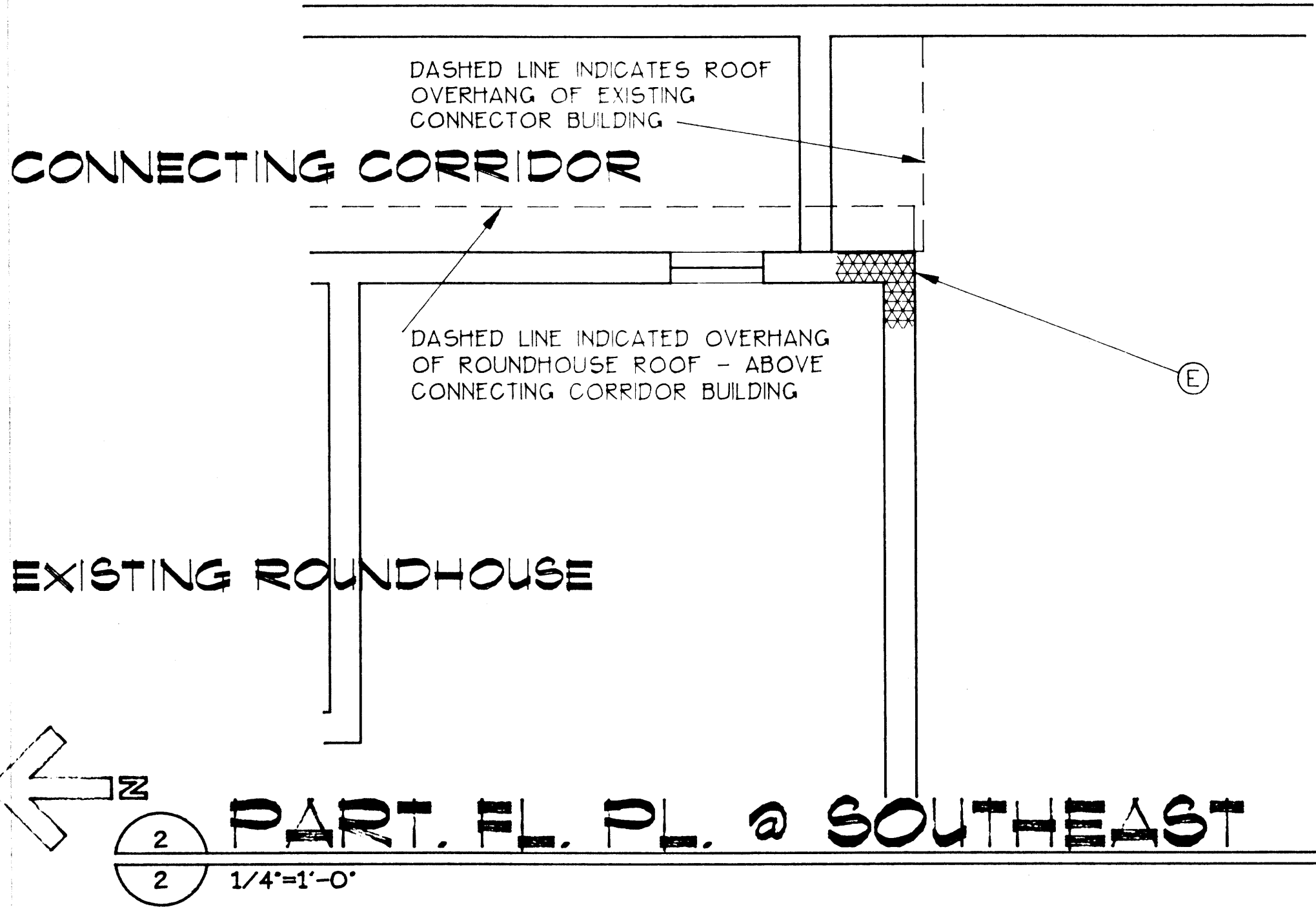

**ORIGINAL ENGINE HOUSE**

OHAMA, NEW MEXICO

Prepared for the  
**CUMBRES AND TOLTEC SCENIC RAILROAD**

By  
John D. Napley AIA, RA - May, 1980  
Surveyed and Inspected - April, 1980  
Inspection Team Members  
John + Janet Napley